



**FSA**<sup>®</sup>

FENESTRATION  
SOLUTIONS  
AUSTRALIA

EVO<sup>®</sup>  
TIMBER SERVERY





MAKING  
LIFE  
BETTER

## WHAT WE STAND FOR

Everyday we live our overarching purpose; to make life better for our team, our customers and to drive our industry forward. To be better than yesterday and committed to a better tomorrow through everything we do.

Ultimately, we inspire architectural innovation and improve homes to create enjoyable and efficient lifestyles. We search the world over to source the most desirable, innovative and superior products available for the Australasian market. Combining stunning aesthetic design, state-of-the-art features, and first-class thermal efficiency, FSA introduces incredibly smart solutions for Australian window & door manufacturers and their customers.

Our experience and research reflects a detailed understanding of local and international markets, technical expertise and a dedication to exceptional customer service and streamlined support. This is exemplified in our extensive portfolio demonstrating our commitment to making life better.



[www.fsa-us.com.au](http://www.fsa-us.com.au)

4	OVERVIEW
	<b>Functions</b>
	<b>Applications</b>
5	GALLERY
7	TECHNICAL SPECIFICATIONS
	<b>Profiles</b>
	<b>Mounting Details - Frame</b>
	<b>Mounting Details - Sash</b>
10	ORDERING INFORMATION
	<b>Fentec® Servery Kit</b>
11	AUTOMATION ACCESSORIES
	<b>Daisy WiFi Controller</b>
	<b>Wall Mounted Controller</b>
	<b>Fentec® Rain Sensor</b>
	<b>Wind Sensor</b>

Full Opening

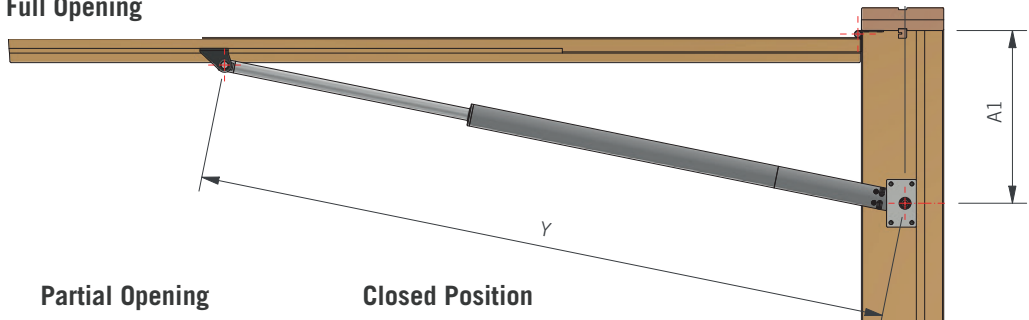

Partial Opening

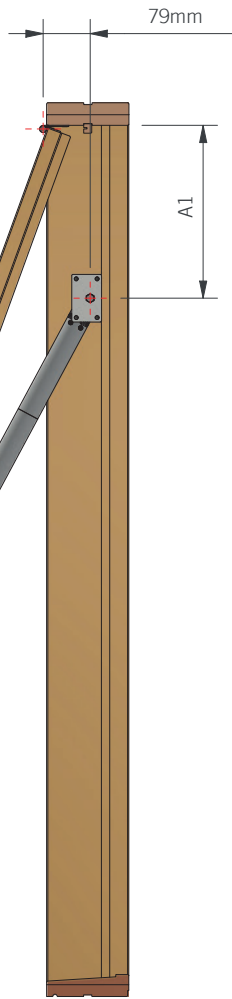

Closed Position

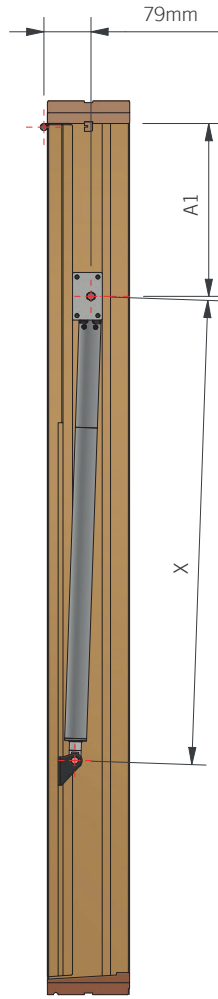

NOTE: Jamb covers not shown

MOTOR SETS				
Set	Stroke	X	Y	Strength (N)
A	150	515	665	1200
B	200	565	765	1200
C	300	665	965	2500
D	400	765	1165	2500

POSITION	
Motor Pos.	A1 (mm)
1	78
2	128
3	210
4	293

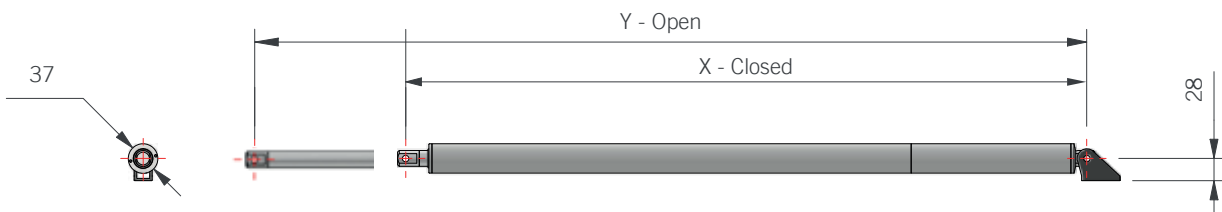

**APPLICATIONS**

Sash Height (mm)	Sash Width (mm)	Total Glass (mm)	Approx Sash Weight (kg)	Motor Set	Frame Pos. A1	Sash Pos. (mm) A2
700	1200	8	24	A	1	590
	1500		30			
	1800		35			
	2000		39			
900	1200	8	30	B	2	690
		10	34			
	1500	8	36			
		10	42			
	1800	8	43			
		10	49			
	2000	8	47			
		10	54			
1200	1200	8	38	C	3	872
		10	44			
		12	50			
		16	61			
	1500	8	47			
		10	54			
		12	61			
		16	76			
	1800	8	55			
		10	64			
		12	73			
		16	90			
	2000	8	61			
		10	70			
		12	80			
		16	100			
1500	1200	8	47	D	4	1055
		10	54			
		12	61			
		16	76			
	1500	8	57			
		10	66			
		12	75			
		16	94			
	1800	8	67			
		10	78			
		12	90			
		16	112			
2000	8	74				
	10	86				
	12	99				
	16	124				
1800	1200	8	55	D	4	1055
		10	64			
		12	73			
		16	90			
	1500	8	67			
		10	78			
		12	90			
		16	112			
	1800	8	79			
		10	93			
		12	107			
		16	134			
	2000	8	87			
		10	102			
		12	118			
		16	149			



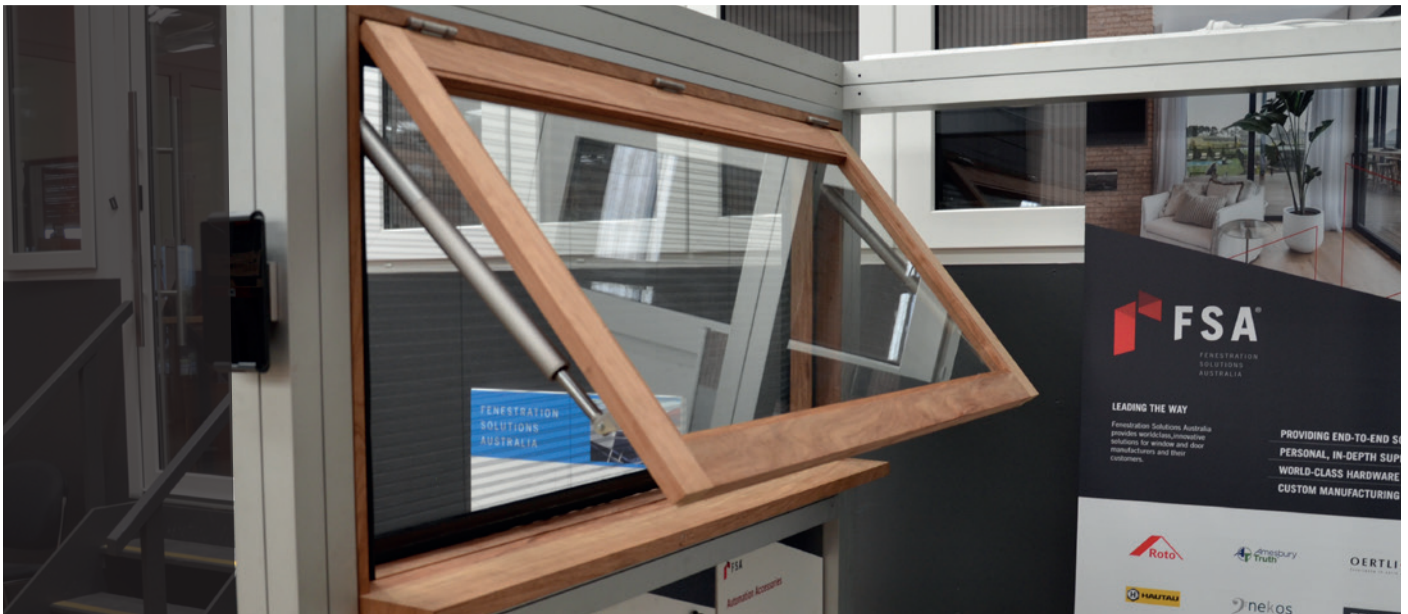

PROFILES

Jamb Profile

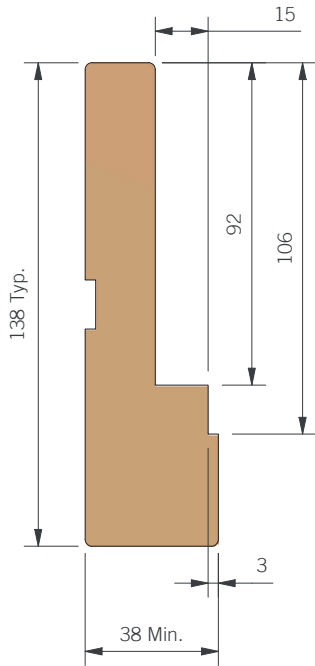

Jamb Cover Profile

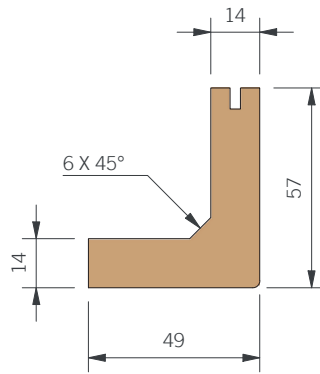

Sash Section - Stile Detail

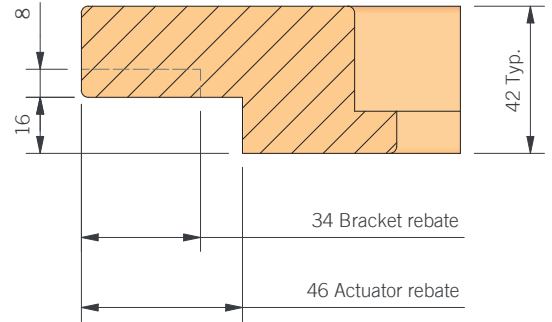

Head Profile - Typical

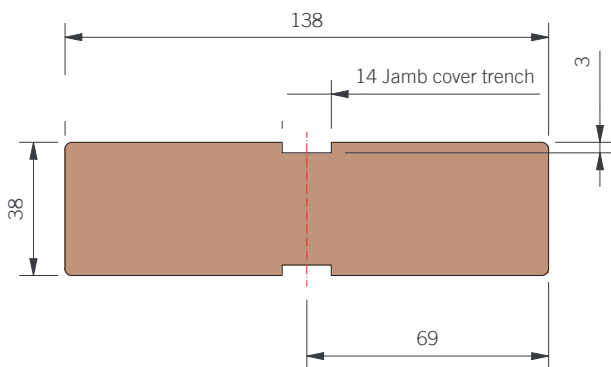

Sill Profile - Typical

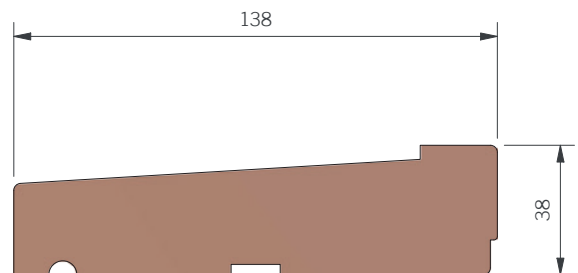

# MOUNTING DETAILS - FRAME

## Frame Bracket Placement

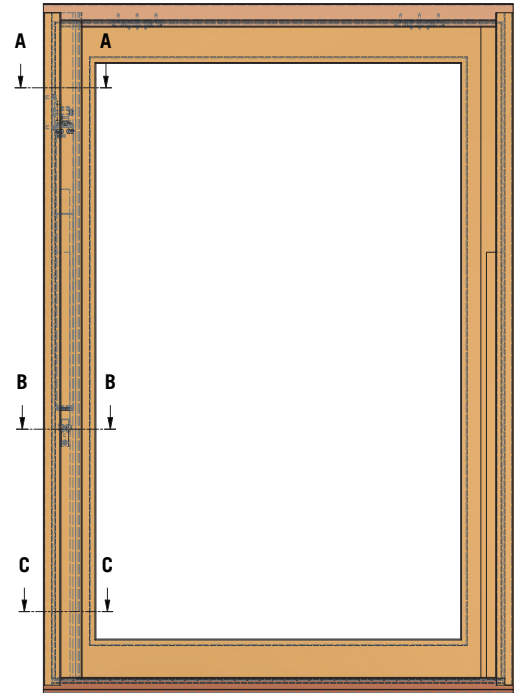
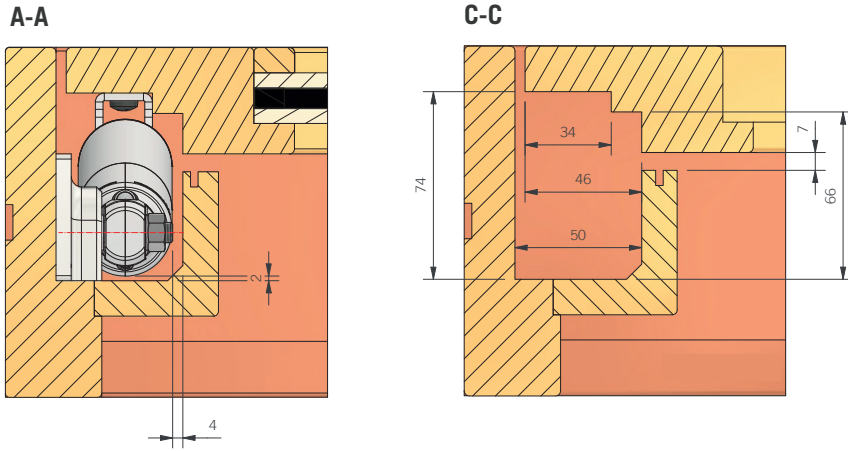

## Frame Bracket Location

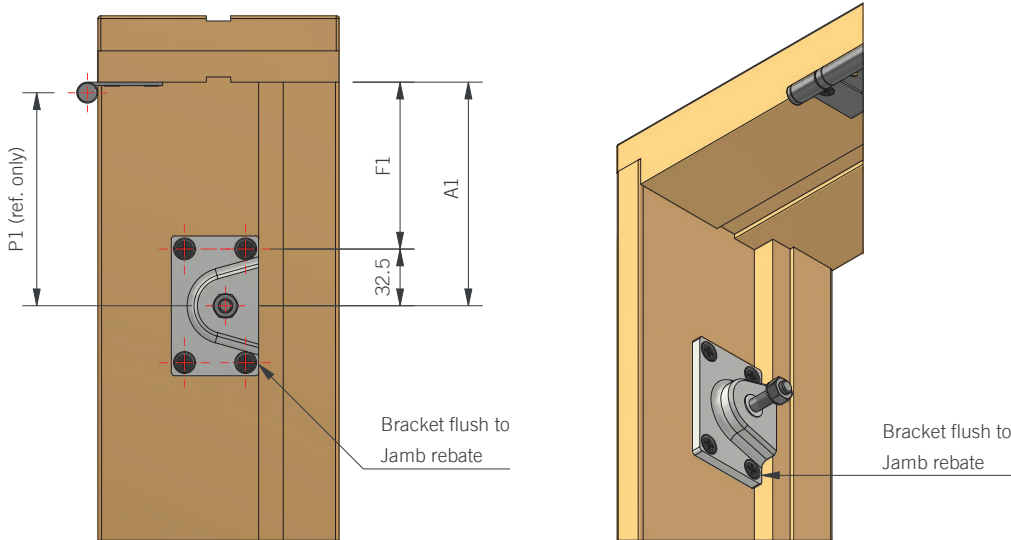

## Frame Bracket Hole Detail

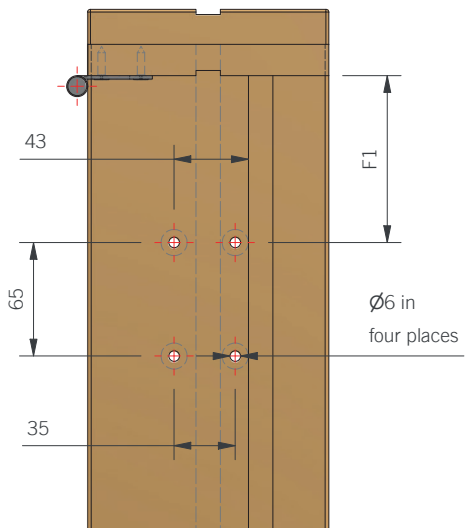

## Outside View

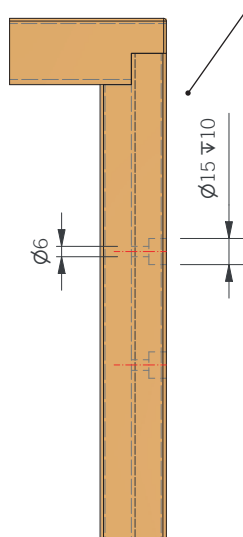



## MOUNTING DETAILS - SASH

### Sash Bracket Placement

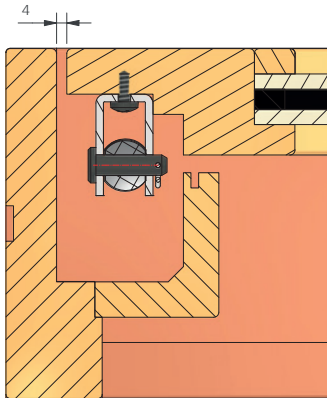

B-B

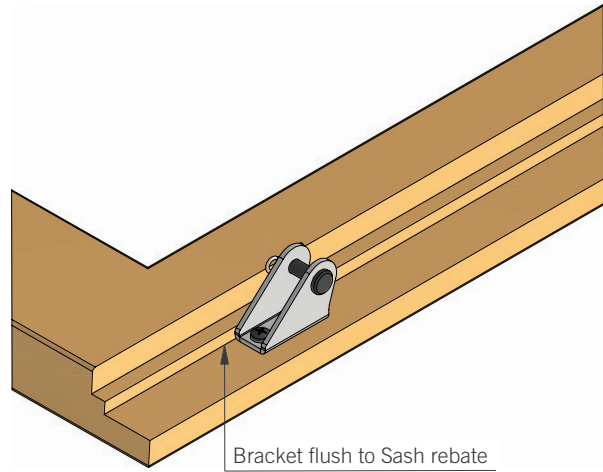

### Sash Bracket Location

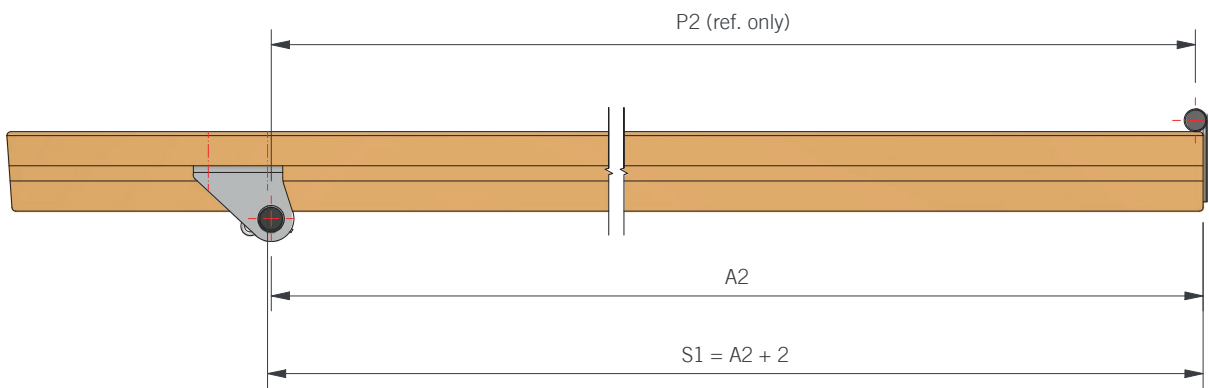

### Sash Bracket Hole Detail

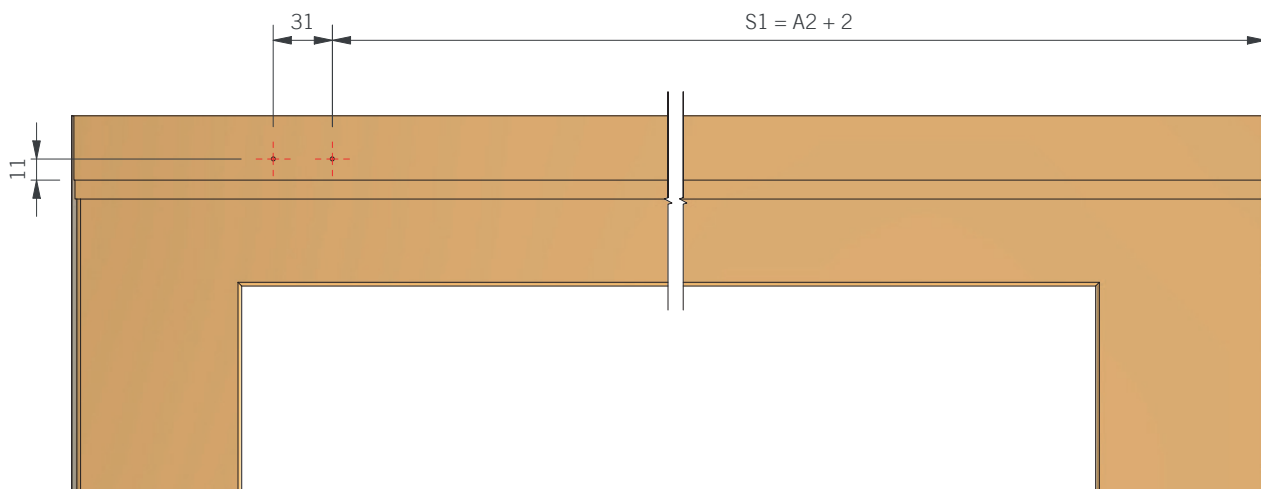

**FENTEC® SERVERY KIT**

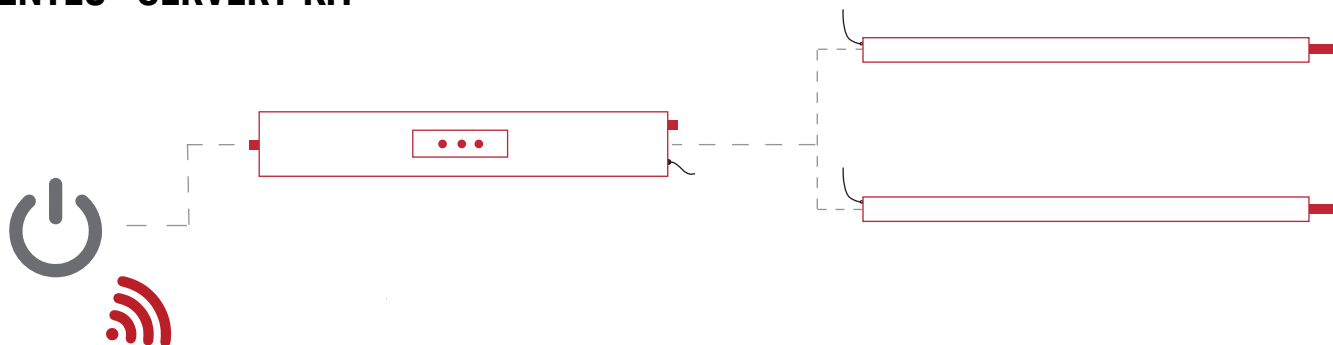

**Optional Extras:**



Daisy



Rain Sensor

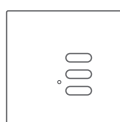

Wall Mount Remote

FENTEC® AUTOMATED SERVERY KIT			
Part No.	Power Supply	Output	Motor Set
F-SERVT-A	240V	24V	A
F-SERVT-B	240V	24V	B
F-SERVT-C	240V	24V	C
F-SERVT-D	240V	24V	D

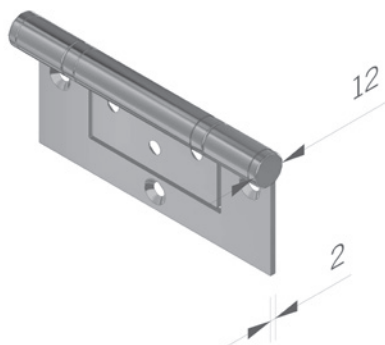

100 X 74 FAST FIX HINGE ST9 - 304 STAINLESS		
Part No.	Colour	Pair
SB-45144	SSS - Satin Stainless Steel	Yes
SB-55144	MBK - Matt Black	Yes

Please contact FSA if alternative hinges are used.

**Key Features:**

- Kit Fully Pre Programmed
- Closed 916mhz Frequency
- Dual Synchronised Actuators
- Simple touch pairing for additional remotes
- Optional Weather Sensors for climate control
- Optional Smart Phone control over Wi-Fi via “Daisy” application
- Bluetooth Smart Phone control via TMATE
- Possibility to incorporate blinds, awnings, louvres, as well as integration with Home Automation systems

DAISY

TMATE

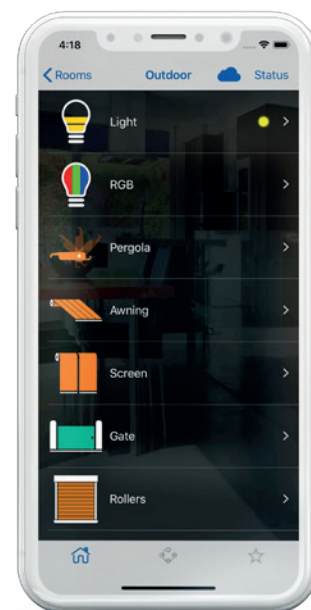

**For the full range of accessories please refer to FSA TELECO Catalogue for Full details.**

## DAISY



DAISY CONTROLLER VIA WIFI			
Part No.	Power Supply	Protection Rating	Dimensions
TE-DAISY	240V	IP20	115x65x40mm

### Key Features

- Daisy lets you interact with all automated systems from anywhere in your home, even from a distance, with Smartphone or Tablet
- Simple to create scenes and programmable weekly timer
- Remote control via Wi-Fi through the creation of a free account in the Teleco Cloud
- Voice control of Teleco systems using the Google Home or Amazon assistant
- Compatible with any Android (version 4.4 and later) and iOS (version 10 and later) device. We recommend installing the latest version of the operating system.

## WALL-MOUNTED CONTROL



3 COMMANDS FOR 1 MOTOR				
Part No.	Lithium Battery	Protection Rating	Dimensions	Colour
TE-WM3RWH	CR2430	IP20	86x86x9.5mm	White

### Key Features

- Sleek wall mounted transmitter that can control multiple devices
- One touch programming keeping things simple and hassle free
- 916Mhz frequency for secure and robust transmitting

## FENTEC® RAIN SENSOR KIT



240V RAIN SENSOR KIT - WIRELESS			
Part No.	Power Supply	Protection Rating	Dimensions
F-RAINW	24Vdc	IP65	130x50x37mm

### Key Features

- Wireless connection
- LED indications for sensor status feedback sensor
- Heating function to avoid false activation due to ice or snow
- Programming magnet to configure the desired sensitivity and heating function without opening the device
- Fixing support supplied
- Equipped with automatic survival signalling

Full kit includes 240V power supply and 24Vdc transformer.

## WIND SENSOR



WIND SENSOR WIRELESS		
Part No.	Protection Rating	Dimensions
TE-WIND	IP44	11x165x121mm

### Key Features

- Compatible with the 4 motor controller kit
- Select from 8 wind speeds, from 40Km/hr to 75Km/hr
- Can be connected to up to 3 controllers
- Potential to manage up to 12 individual windows or 24 syncro motors



**FSA<sup>®</sup>**

[www.fsa-aus.com.au](http://www.fsa-aus.com.au)